

Z KOVE



450RR

COMMUNICATION GUIDE

KOVEMOTO 450RR

2026



FOCUS ON PERFORMANCE

Disclaimer:

This document is for KOVE dealer network internal use only, for product training and reference. It must not be shared directly with end customers.

All dealer partners are required to read and understand the product features and key highlights to ensure accurate product introduction to customers.

For external communications, do not mention other brands or competitors. If this document is sent externally in any form, all competitor comparison content must be removed



ABOUT 450RR

EXCEPTIONAL-VALUE INLINE-FOUR PERFORMANCE BEAST,
BRINGING TRACK DNA WITHIN REACH

KOVE 450RR is a track-focused machine built for pure performance and rider enjoyment. With a “race-to-road” mindset, we bring lessons from top-level racing, including WSBK, straight into the production bike. Whether you chase precise corner control or live for the high-rev inline-four soundtrack, KOVE 450RR keeps the ride direct, engaging, and rewarding.

KOVEMOTO 450RR



KOVEMOTO 450RR

ABOUT 450RR

EXCEPTIONAL-VALUE INLINE-FOUR PERFORMANCE BEAST,
BRINGING TRACK DNA WITHIN REACH

Positioned as the accessible inline-four dream bike, it delivers high-rev soundtrack and track-level-control with outstanding value, making real track-bred performance easier to reach.

STRONG POWER >>>>

A high-rev inline-four heart with a 14,000 rpm scream, delivering a one-of-a-kind soundtrack and top-end excitement in its class.

KOVMOTO 450RR



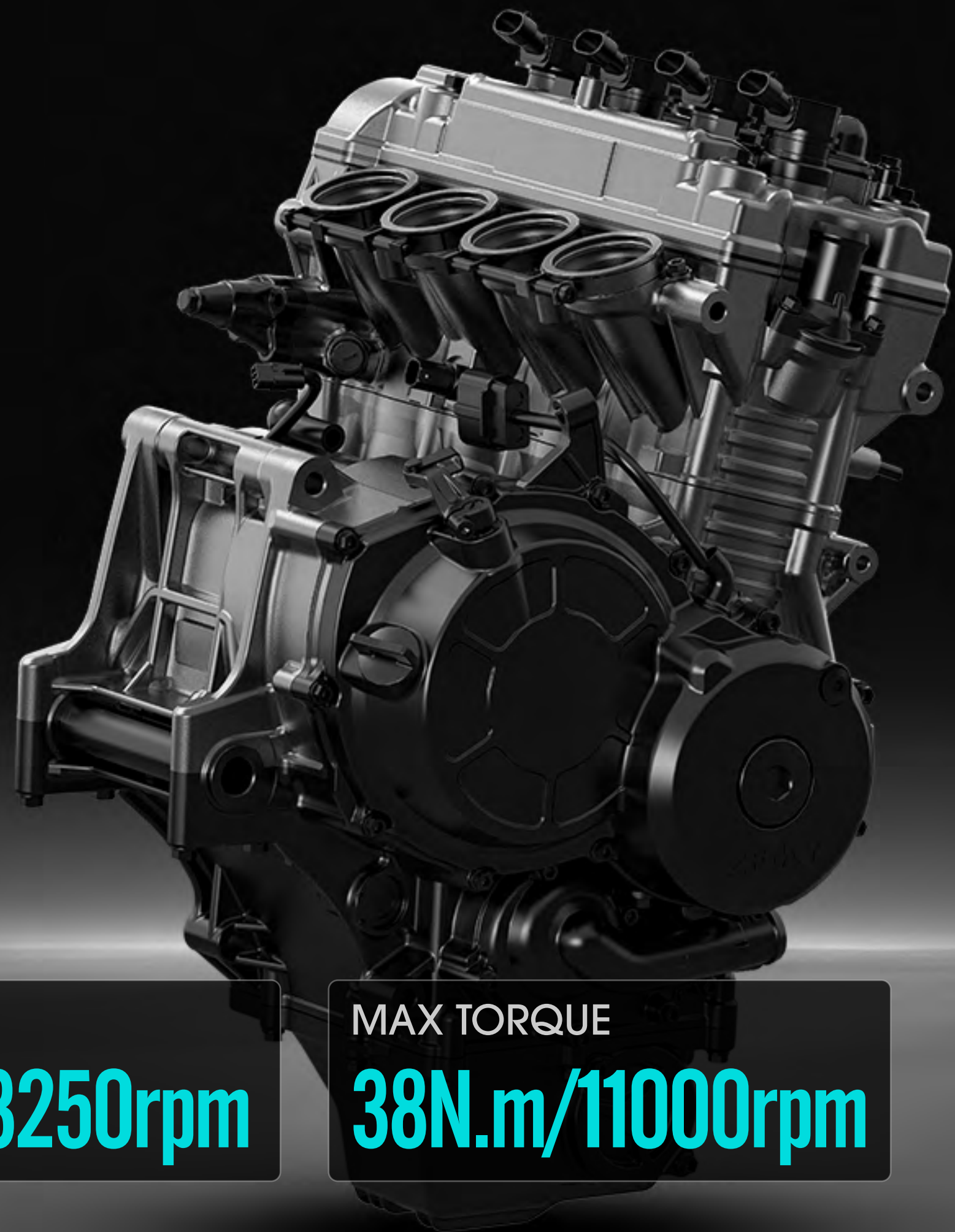

MAX POWER

49kw/13250rpm

MAX TORQUE

38N.m/11000rpm

HIGH-REVVING INLINE-FOUR ENGINE

443cc inline-four making 66.6 hp at 13,250 rpm, paired with a 12.9:1 compression ratio for explosive top-end performance. Adopts DLC-coated components to minimize friction, ensuring outstanding high-rpm stability and durability.

KOVEMOTO 450RR

STRONG POWER

RAM AIR BOOST

Above 150 km/h, the ram-air intake adds up to 3 PS, keeping the 450RR pulling harder as speed builds and giving you stronger drive for straight-line sprints and decisive passes

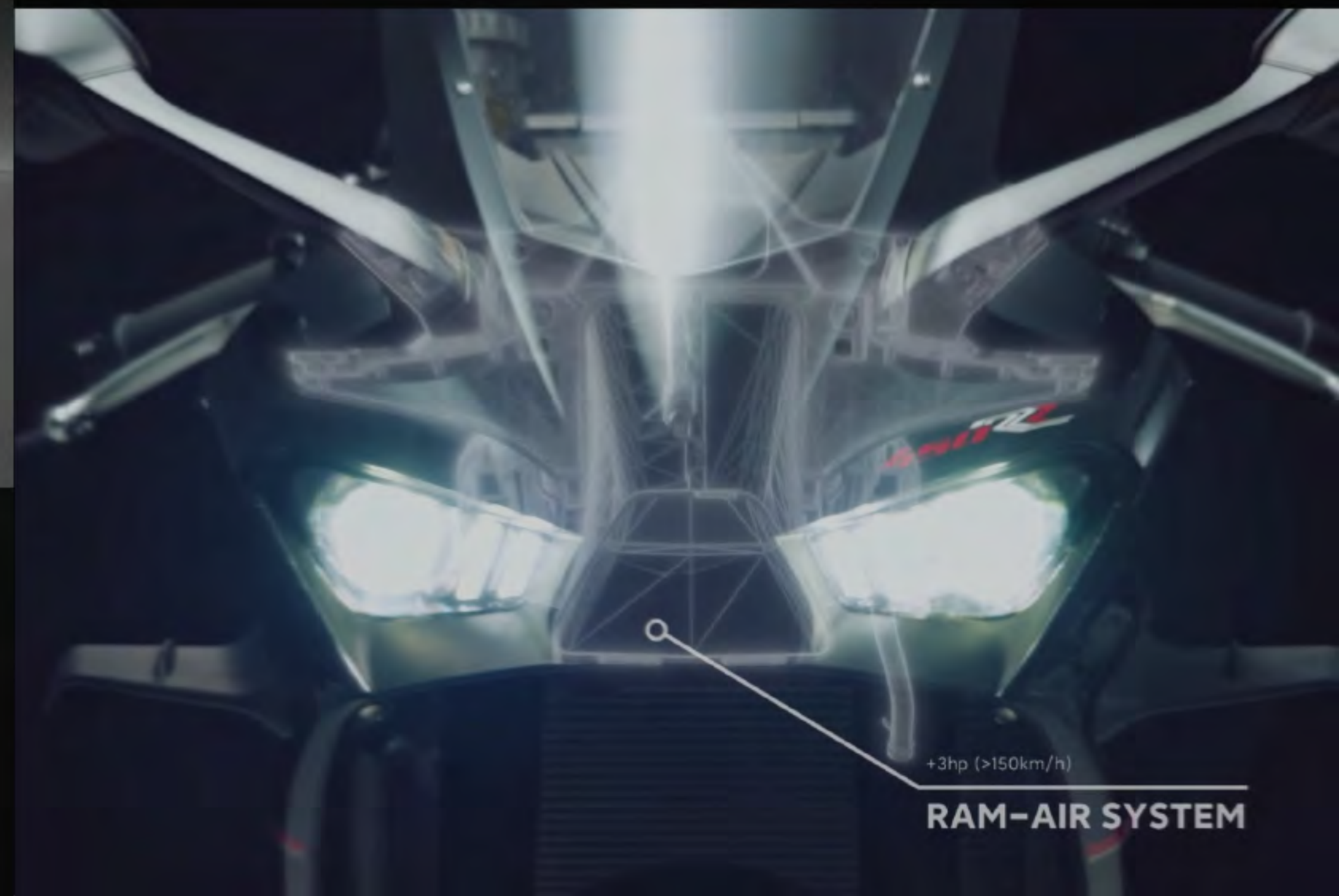

+3hp (>150km/h)

RAM-AIR SYSTEM



STRONG POWER

PERFORMANCE TONE

With specific calibration of the intake/exhaust system and valve timing, the 450RR delivers a soundcharacter that feels almost “mechanically supercharged-like”: dense and smooth at idle or lowspeeds, then sharp and forceful as the revs climb

AUDITORY
EXPERIENCE

KOVEMOTO 450RR



KOVEMOTO 450RR

PRECISION HANDLING >>>>

A light, compact feel that's easy to move around.
Razor-sharp through corners, like a scalpel.

PRECISION HANDLING

Light & Responsive

Curb weight

165 kg

Power-to-weight

0.32

KOVMOTO 450RR

This is enabled by our world-first 3/4 frame

☆Weighing just 7 kg.

☆Refined again using race data from the KOVE Racing Center,

☆delivering a 27% gain in rigidity and torsional resistance.

The lightweight chassis cuts bulk, improves balance, and gives you quicker, more confident cornering.



PRECISION HANDLING

Optimized Ergonomics

Optimized ergonomic triangle with adjustable 785mm-795mm seat height fits the riding posture, softens the aggressive stance, cuts down handling fatigue, and achieves seamless man-machine integration.



Golden Handling Geometry

24.5° rake angle + 98mm trail for golden handling geometry, matched with 28° steering angle and 1385mm shortwheelbase: quick, precise steering, agile at low speeds, and stable in high-speed corners.



PRECISION HANDLING

Winglets & Side Panels: More Than Styling

Winglets — subtle downforce you can feel

At speed, the bike stays calmer and more planted. When you lean in, it feels like an unseen hand pressing the front tire into the tarmac, boosting stability and confidence.

Side Panels — a tailored “riding suit”

Let your legs lock in closer to the bike for a more unified feel, helping reduce turbulence and improving comfort and steering precision.



KOVEMOTO 450RR

TRACK-READY PACKAGE >>>>

Fully equipped from the factory—no extra mods needed.
Ready to meet track-day demands right away.

KOVEMOTO 450RR



TRACK-READY PACKAGE



Professional Tire Specs

120/70ZR17 front + 160/60ZR17 rear tires with professional width ratio deliver direct handling feedback, light and smooth body leaning/straightening, and consistent performance for commuting and track riding.



Tunable KYB Suspension KYB

Fully adjustable KYB upside-down forks, allowing precise damping setup for track sessions or street riding.



Precision Braking

Front 300 mm dual discs with opposed four-piston calipers, paired with dual-channel ABS and TCS traction control to keep safety intact even during aggressive riding.



KOVEMOTO 450RR

RIDER-FOCUSED ELECTRONICS

Makes new riders safer, and experienced riders more focused



RIDER-FOCUSED ELECTRONICS

Beginning Mode

For riders new to this level of performance: aggressive throttle work can catch you off guard — so we've built in factory-default Beginning Mode to keep the ride controlled:

- ◇ Top speed capped at 140 km/h
- ◇ Per-gear max RPM restricted

(Can NOT be manually turned off)

GEAR	MAX. RPM
6	8100
5	9000
4	10000
3	11800
2	12000
N	8000
1	12000



BEGINNING MODE



KOVEMOTO 450RR

Once you log 500 km, the mode automatically disables, unlocking the full 220 km/h top speed.

RIDER-FOCUSED ELECTRONICS

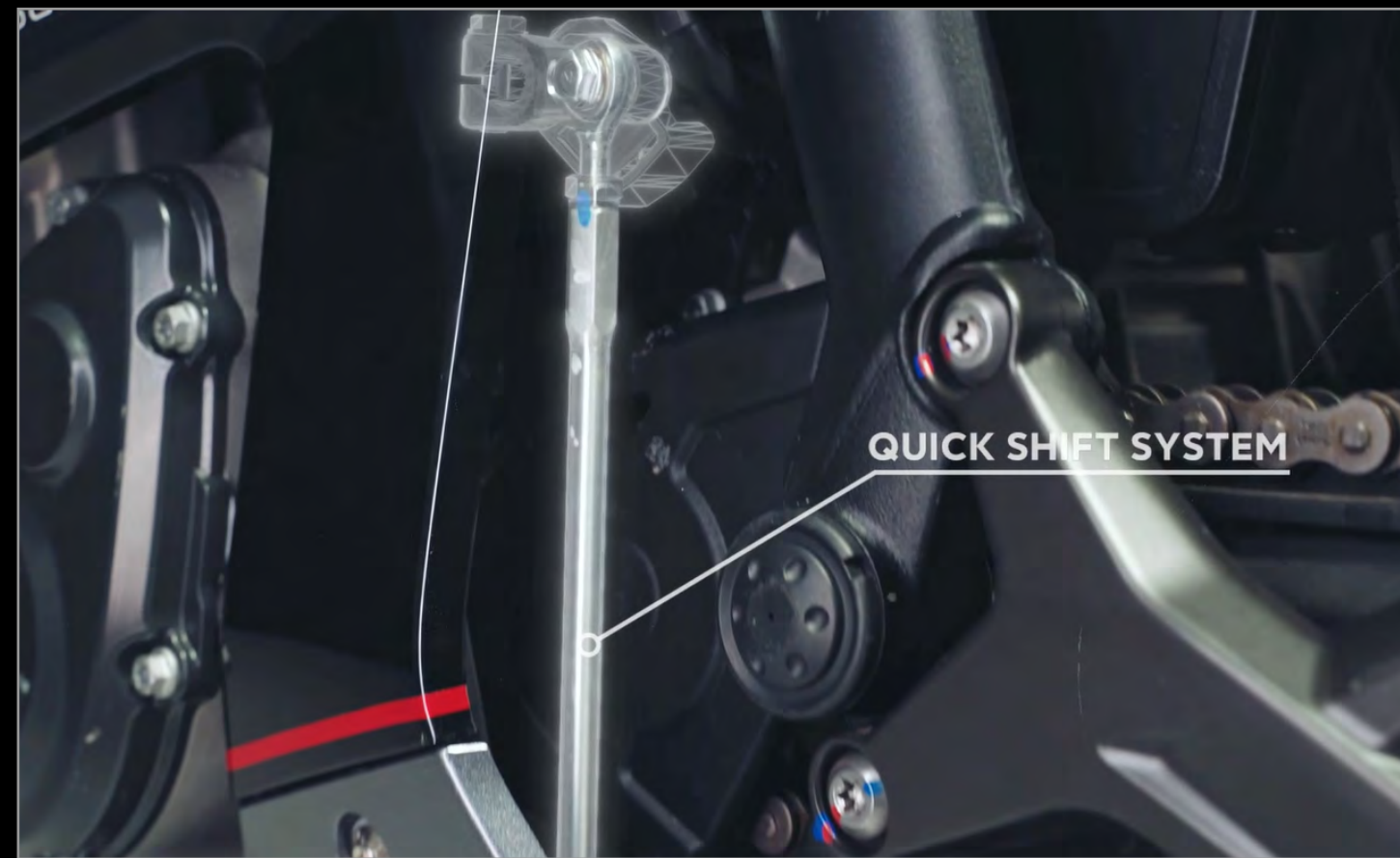

Quickshifter (Upshift)

Clutchless upshifts at speed for smoother, uninterrupted drive.



Launch Control

The system modulates power delivery to launch the bike sharply off the line, with no wheel spin or front-end lift. It delivers maximized, controlled acceleration for starts.

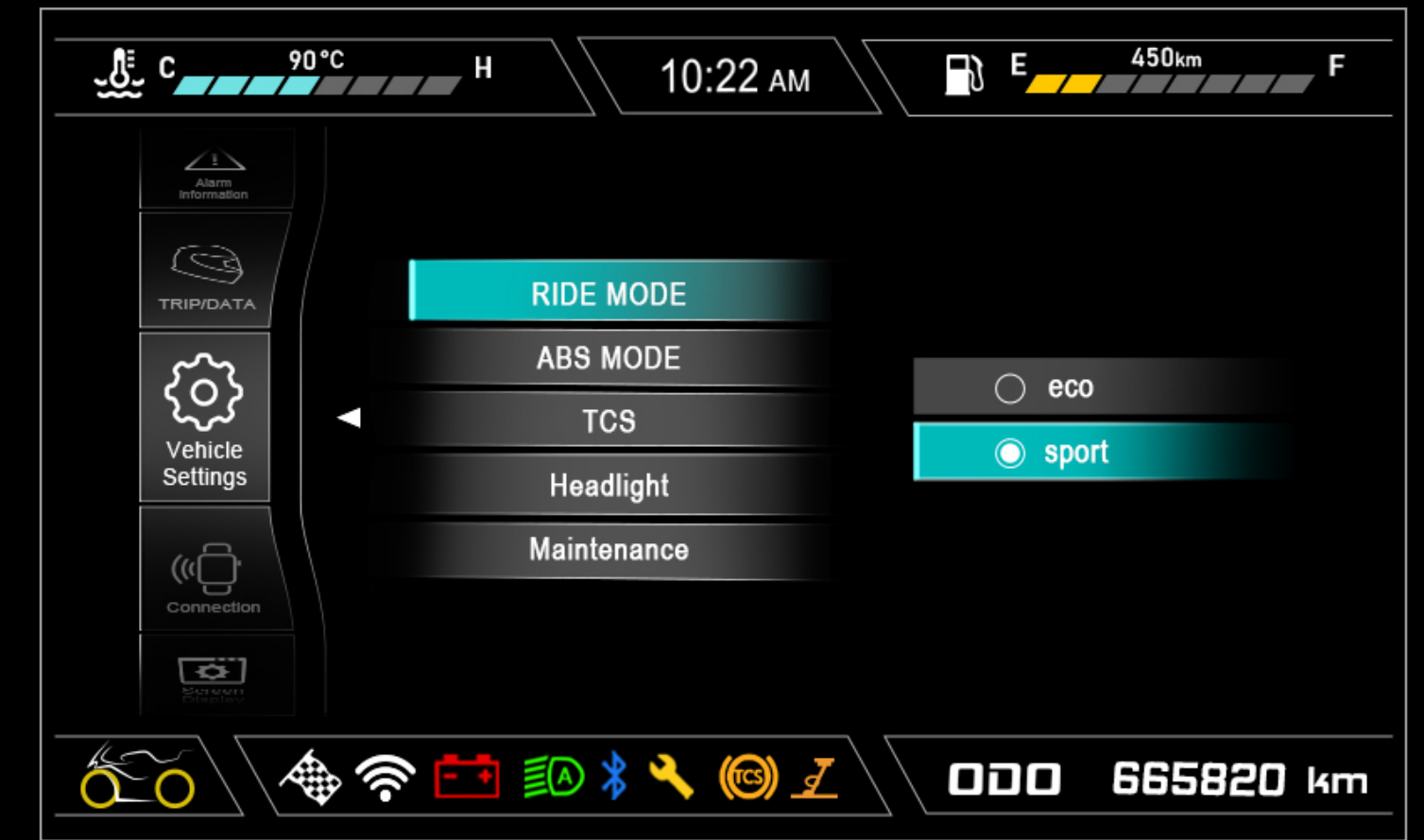

Riding Modes

Sport / Eco tailor power delivery to suit different riding needs and conditions.

OPTIONAL COATINGS

KOVEMOTO 450RR



Storm Black

A layered black-grey finish with subtle gold accents. Under its calm, understated exterior lies a latent DNA of speed, waiting to be unleashed.



Crimson White

A red frame, white body, and smoked windscreen come together to define sporty aesthetics.

SPECIFICATIONS

PRODUCT NAME	450RR
ENGINE STYLE	Inline 4-cylinder, DOHC. water-cooled, 4-stroke
DISPLACEMENT	443cc
BORExSTROKE	59x40.5
MAX POWER	49kw/13250rpm
MAX TORQUE	38N.m/11000rpm
COMPRESS RATIO	12.9:1
CLUTCH STYLE	Wet multi-disc sliding clutch, 6 gears
CLUTCH OPERATING MODE	Mechanical cable
THROTTLE STYLE	Mechanical throttle
POWER MODE	SPORT/ECO
FUEL SUPPLY	EFI
BASIC PARAMETER	
LxWxH mm	2015x740x1090
STEERING ANGLE °	28°
RAKE ANGLE °	24.5°
TRAIL mm	98mm
WHEEL BASE mm	1385mm
SEAT HEIGHT mm	785mm
GROUND CLEARANCE mm	118mm
FUEL TANK VOLUME L	15L
CURB WEIGHT kg	165
FEATURE	
QUICK SHIFT SYSTEM	●
TRACTION CONTROL	●
MAX SPEED	220km/h
STEERING DAMPING	●
RAM INTAKE	●
HIGH RPM	14000rpm

CHASSIS/SUSPENSION/BRAKE	
CHASSIS	HC700+Q355B trellis frame
HANDLE BAR	Aluminum Alloy Split Handlebar
REAR FORK	High strength steel structure stamped, double swingarm
FOOTREST SUPPORT	Aluminum alloy
WHEEL	Aluminum alloy casting
FRONT TIRE	120/70ZR17
REAR TIRE	160/60ZR17
FRONT SUSPENSION	KYB, φ41mm fully adjustable upside down front fork
REAR SUSPENSION	KYB fully adjustable, external airbag, rear shock absorber
F/R SUSPENSION TRAVEL	112/40
FRONT BRAKE	Double disc, opposed 4-piston calliper/ABS(TAISKO)
REAR BRAKE	220mm single disc, 1-piston calliper (TAISKO)
ABS&CBS	Dual ABS
ELECTRIC SYSTEM	
KEY	Normal Key
BATTERY	12V4AH Lithium battery
HEAD LIGHT	LED (AUTO)
DRL	LED
TAIL LIGHT	LED
TURN SIGNAL	LED
DASHBOARD	TFT
NAVIGATION	Mobile screen projection
STICKER&COLOR	
COLOR	White/Black

TRACK DAYS & MOUNTAIN RIDES

With its lightweight chassis, potent high-revving engine, and full electronic control system,

it delivers thrilling cornering and acceleration in complete safety.

Target Riders: Performance enthusiasts, track day riders, cornering fanatics

KOVEMOTO 450RR



URBAN COMMUTING & STYLISH EXPRESSION

Its head-turning cyber-race styling and distinctive inline-four exhaust note make it a standout even for daily city riding.

Target Riders: Style seekers, exhaust sound fanatics

KOVEMOTO 450RR



KOVE 450RR VS. COMPETITIVE PRODUCTS

	Yamaha R3	450SR	450RR	Advantage (450RR)
Max.power	27kw	37kw@9500rpm	49kw@13250rpm	Highest peak power, stronger high-rev output
Max.torque	28.4N.m	39N.m@7600rpm	38N.m@11000rpm	Higher rev range torque, stronger high-speed acceleration
Fuel tank	14L	14L	15L	Larger capacity, longer riding range
Curb Weight	167kg	168kg	165kg	Lightest weight, better handling agility
Power to weight ratio	0.16	0.22	0.32	Highest power-weight ratio, top acceleration & performance
Seat height	780	785/795	785-795	
Throttle form	Mechanical throttle	Mechanical throttle	Mechanical throttle	
ABS	ABS	ABS	ABS	
Clutch	/	FCC Slipper clutch	Wet multi-disc sliding clutch, 6 gears	
Ram Intake	-	-	●	Exclusive ram intake, boosts high-speed power
Quick Shift System	-	-	●	for clutchless fast shifting
Lights	Headlights LED/steering halogen	LED	LED	Full LED system, brighter & more stylish
Brakes	NISSIN Double front and single rear	Brembo front calipers Front four Hangte, rear single J.Juan	TAISKO	
Suspension	KYB inverted suspension with adjustable rear preload	Inverted suspension (Yu'an)	KYB fully adjustable	KYB fully adjustable, track-grade tuning capability
Rear fork	Double swing arm (sheet metal)	Double swing arm (sheet metal)	High strength steel structure stamped, double swing arm	higher rigidity & stability

KOVEMOTO 450RR

KOVE 450RR is more than just a motorcycle – it is an accessible ticket to the track. With top-level lightweight technology, the fascinating sound of a high-revving in-line-four engine, and a fullset of track-grade configurations, it truly makes the 4-cylinder performance dream achievable for everyordinary rider.



KOVE

Tibet New Summit Motor Co.Ltd

Tibet Summit Colove Motorcycle Sales Co., Ltd

Add: No.2, Xiangyu Rd, Airport industrial Zone,
Liangjiang District, Chongqing, China

Website: www.kovemoto.com / Email: export@kovemoto.com

